

T-500

Wall-mounted thermostatic bath-shower mixer, with diverter-flow regulator

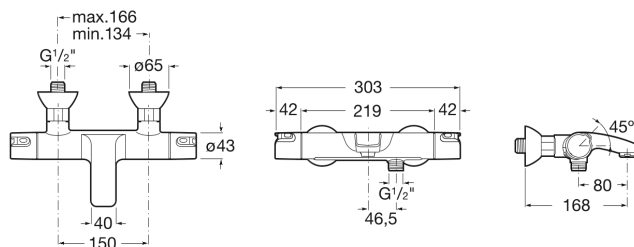

TECHNICAL DRAWINGS



FEATURES

Application place: Bathtub, Shower

Diverter-flow regulator

Faucet type: Thermostatic

Finish: Chrome

Installation type: Wall-mounted

NumberOfWaterInlets: 2

Sustainable product



Evershine



Quick reaction



SafeTouch



Safety 38°

BOUGHT TOGETHER FREQUENTLY



Floorstanding columns

525866800

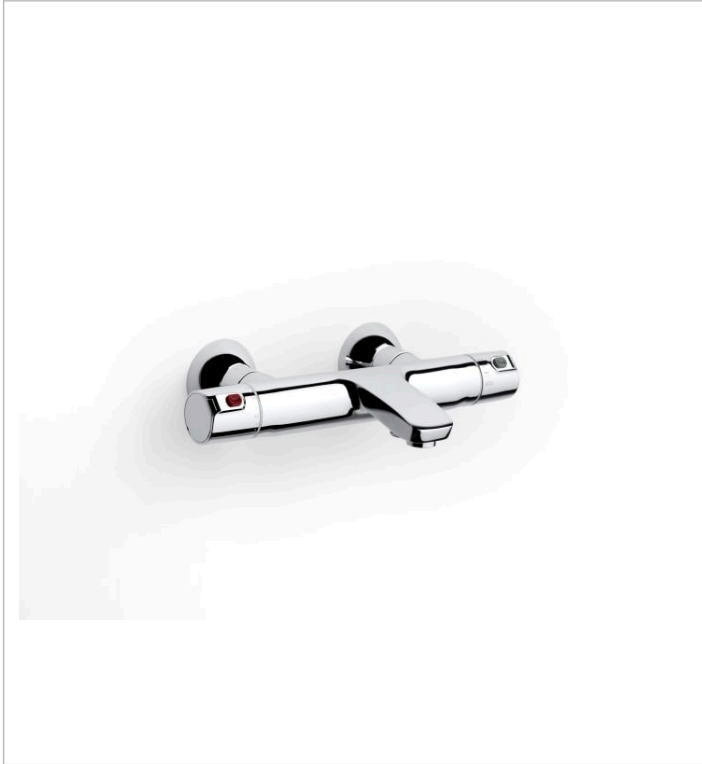

## T-500

The T-500 series offers you the benefits and functionalities that characterise thermostatic faucets: water and energy saving, safety and comfort.



### INSTALLATION AND USER MANUALS



[Installation Handbook](#)