

PALS

Wall-mounted shower mixer

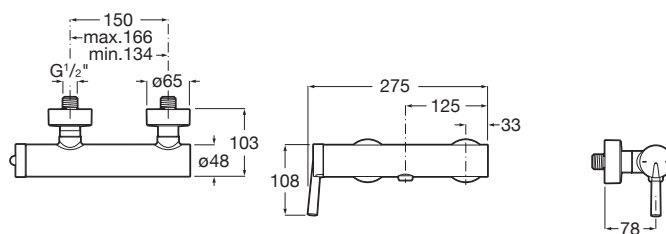

TECHNICAL DRAWINGS



FEATURES

Wall-mounted shower mixer.

Application place: Shower

Faucet type: Single-lever

Finish: Chrome

Handle position: Top

Installation type: Wall-mounted

Waste type: Waste not included



Evershine



Joystick cartridge



Pals

Straight lines, cylinders and different diameters come together in a modern collection with an array of configurations and originality as a distinguishing trait.



INSTALLATION AND USER MANUALS



[Installation Handbook](#)